

# drop arm awning

## drop arm awning system

with compression springs

The Drop Arm Awning gives you the protection of a fixed awning, however, the compressed spring arms afford you the flexibility to retract the awning whenever you wish, to the degree that you choose. This Awning features a roller tube, front bar and compressed spring arms. The most outstanding feature of this awning system is that you decide the level of shade and privacy you require, and are designed to withstand high winds and adverse weather. Motorisation recommended for 2nd level installation.

Motorisation: When motorised we use Windoware motors (includes wind sensor).



drop arm

MADE IN FRANCE

windoware™  
www.windoware.net.au

12  
MONTH  
Guarantee

# drop arm awning

## componentry diagram

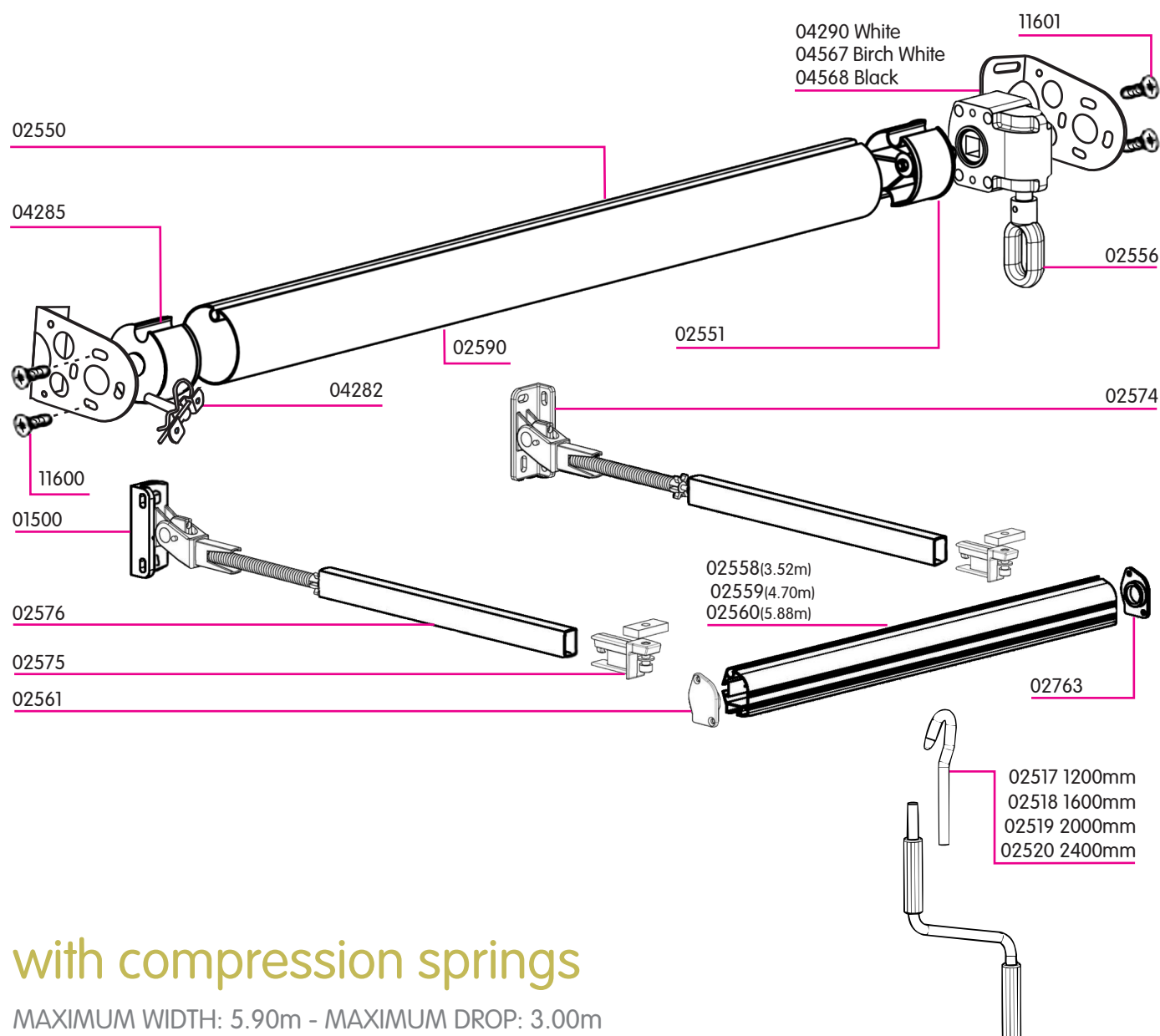

## with compression springs

MAXIMUM WIDTH: 5.90m - MAXIMUM DROP: 3.00m

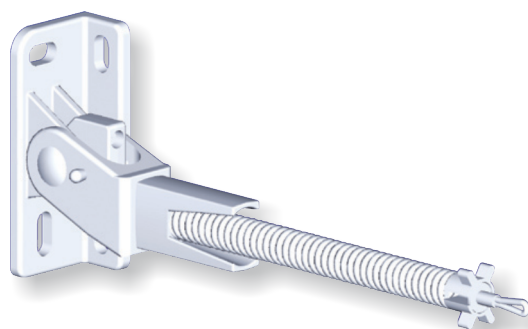
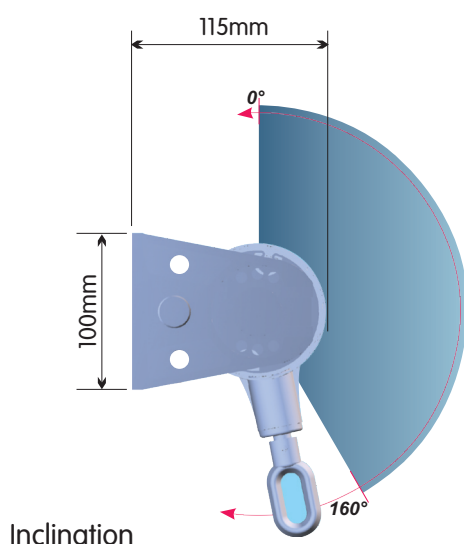

Drop arm awning with  
compression spring in  
arms fully adjustable to 160°

# drop arm awning

## awning system components



### Pivot Pin & Plate

COLOUR: Stainless Steel  
PACK: 1

04282



### Bolts & Nuts

for Pivot Pin & Plate

COLOUR: Stainless Steel  
PACK: 200

11601



### 78mm Hollow Idler End

COLOUR: Mill  
PACK: 1

04285

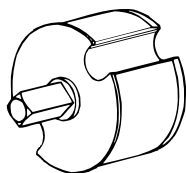

### Square Drive

For 78mm Tube.  
Square pin is inserted into gearbox for positive drive.

COLOUR: Mill Finish  
PACK: 1

02551

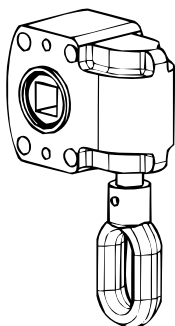

### Gearbox 9:1 Ratio

Strong cast winches provide smooth action. (For less than 6m widths)

COLOUR: White  
PACK: 1

02556

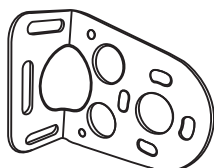

### Fixing Bracket 80mm

113mm Projection  
PACK: 1

04290 White

04567 Birch White

04568 Black

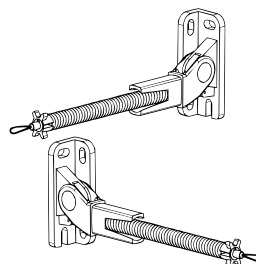

### Compression Springs

COLOUR: White  
PACK: 1

01500 Left

02574 Right

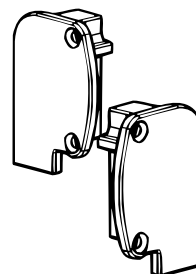

### Front Bar End Caps

Stylish end caps for front bar.  
Now pre-drilled for easy assembly.

COLOUR: White  
PACK: 1

02561 Left

02763 Right

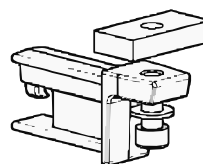

### Front Bar Clamp

Inserted into arm extrusion attachment to front bar.

COLOUR: White  
PACK: 1

02575

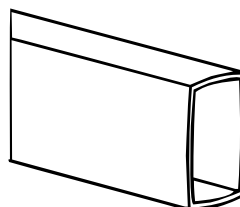

### Drop Arm Extension

Supplied in 6m lengths gives you the option of specialised projections

COLOUR: White  
PACK: Per Length

02576



# drop arm awning

## awning system components

### TUBES

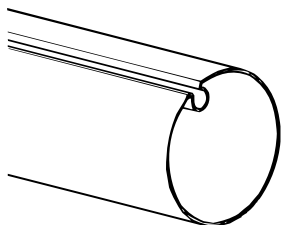

#### 78mm Keyway Tube

78mm tube prevents fabric sagging and provides extra strength.

3.52m STEEL - 1mm wall thick

02548

4.70m STEEL - 1mm wall thick

02549

5.88m STEEL - 1.2mm wall thick

02550

GALVANISED  
UNIT: Per Length

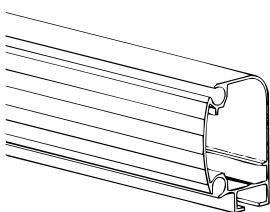

#### Front Bar

Heavy duty aluminium front bar design provides minimal flex. Fabric comes over the top and prevents spline pulling out and water trapping in spline grooves.

3.52m EXTRUSION

02558

4.70m EXTRUSION

02559

5.88m EXTRUSION

02560

COLOUR: White  
PACK: Per Length

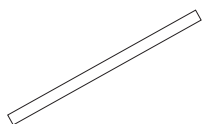

#### Hard Spline 6mm

Made from strong PVC, easy to use. Fits snugly into spline grooves.

COLOUR: White

PACK: 300m

02590

### CRANK HANDLES

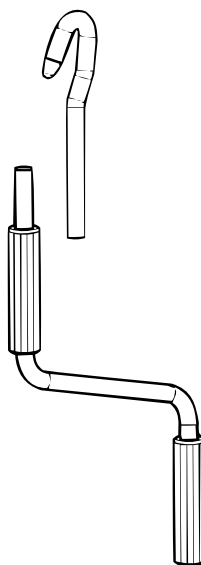

#### Hand Crank

Available in four sizes depending on the height of your awning. Fits snugly into the winch and the PVC handles allow easy operation. Solid Construction. (1600mm Supplied with frames)

COLOUR: White  
PACK: 1

1200mm

02517 White

1600mm

02518 White

2000mm

02519 White

2400mm

02520 White

